



# CBS HOME



Constructing the future with



## EASY SAID, EASY DONE

The innovative Compound Building System from CBS Home makes building easier - in the truest sense of the word. The wall and ceiling elements are made of porous lightweight concrete with a density of 600 kg/m<sup>3</sup> or more. This completely encases the filigree supporting structure made of galvanised sheet steel and thus additionally reinforces it. The intelligent combination of the two materials creates solid wall and ceiling elements with a comparatively low weight.

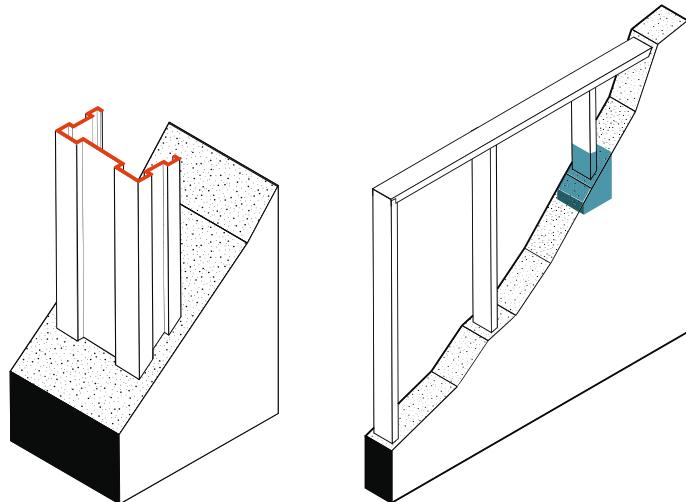

## YOU CAN SAVE YOUR-SELF THE TROUBLE

Due to the high degree of customisation of the serially produced CBS elements, interfaces on the construction site are reduced to a minimum. In addition, the overall construction time is reduced due to the high assembly speed of the construction elements.

## THERE'S MORE

Window, balcony and door elements can be pre-assembled on request. Empty pipes, empty sockets, sanitary modules and domestic ventilation with heat recovery can also be installed at the factory. The exterior walls can be completed with full thermal insulation in various insulation thicknesses. It is also possible to apply commercial levelling on request.



## HEALTH!

Porous lightweight concrete in combination with galvanised sheet steel as materials are environmentally friendly, as their recycling rate is over 90%, which contributes to a significant reduction in environmental pollution.

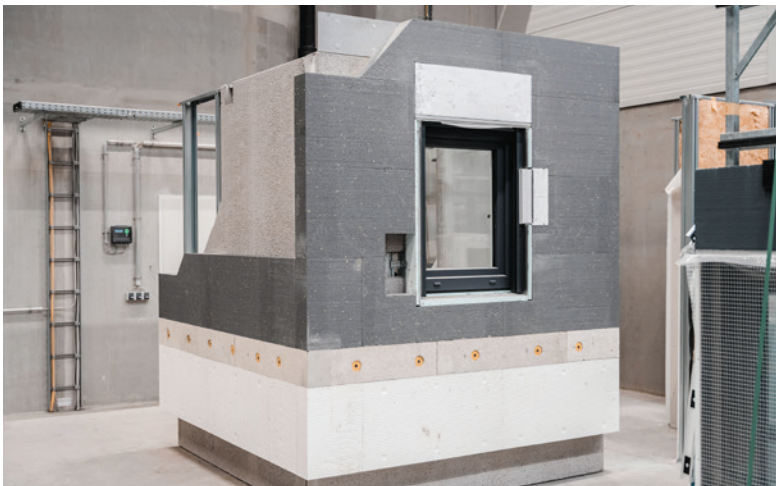

## THINKING BEYOND

The CBS system has already been patented in over 60 countries. All relevant approvals in the areas of stability, fire, heat and sound insulation have been obtained. Together with our customers, we are getting closer to our vision every day: we are revolutionising the construction industry in a sustainable way and creating economical living space - everywhere and for everyone!

### BASIC ELEMENT

- Lightweight concrete wall with integrated lightweight steel structure
- Maximum dimensions 3 m x 10 m
- Optional integrated windows and shading, flush-mounted electrical and sanitary elements, as well as pre-installed EPS insulation
- Concrete types:
  - Lightweight aggregate concrete according to EN 1520
  - Lightweight concrete in accordance with EN 206 + DIN 1045
- Bulk density classes:
  - Lightweight aggregate concrete: 0.8 - 1.4
  - Lightweight concrete: 1.6 - 2.0
- Strength classes:
  - Lightweight aggregate concrete: LAC 6, LAC 8, LAC 10
  - Lightweight concrete: up to LC 40/44
- Compressive strength:
  - 6 N/mm<sup>2</sup> - 44 N/mm<sup>2</sup>

Foto: © Concrete Rudolph GmbH

**Katalog anfordern!**

Mischersysteme  
Zubehör



[kniele.de](http://kniele.de)

**Konusmischer KKM**

Daten & Fakten



[kniele.de/kkm](http://kniele.de/kkm)

Anspruchsvolle Betone – UHPC und dekorativ

# Mischen in 4D: KKM

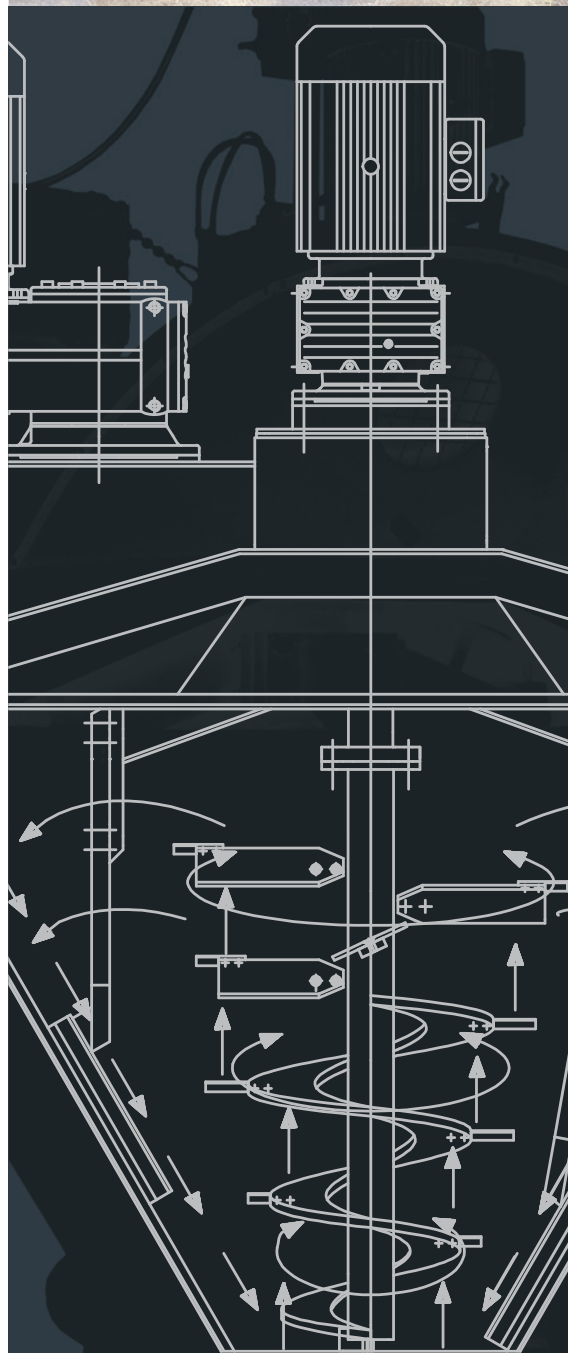

MASTERS OF BLENDING

**KNIELE**





# TIME FOR NEW DREAMS

## *How CBS Home is revolutionising serial construction*

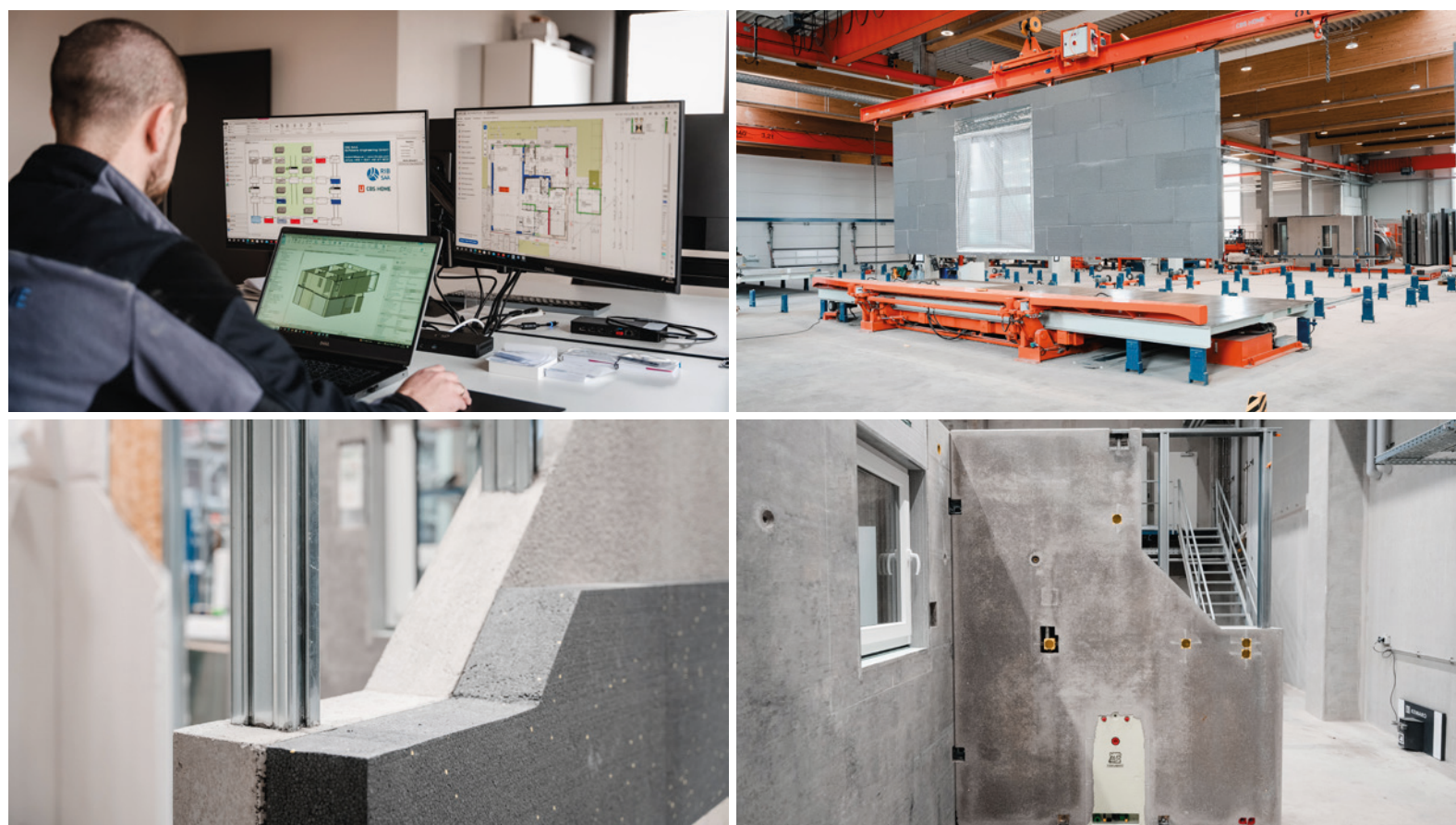

The construction industry is facing major challenges: Costs are rising, skilled labour is more scarce than ever and environmental sustainability is the order of the day. How can we create affordable housing, promote social justice in the world of work and preserve the earth for future generations?

CBS Home has a simple answer to these questions: the Compound Building System. This system creates buildings from just two materials: sheet steel and lightweight concrete. The production of the wall and ceiling elements is highly automated. Assembly on the construction site is completed quickly and is possible in all weathers. The system is suitable for detached houses and apartment blocks as well as public buildings, office complexes and industrial halls.

What is your next project? Regardless of whether you work in the construction industry or would like to live and work in a modern and sustainable way yourself: Make sure you also take a look at the following pages of this brochure! Discover how you can “build the future” with CBS Home - efficiently and individually. We look forward to receiving your enquiry.

## PRODUCTION SITE

CBS Süd GmbH

Im Bettinger 17  
78652 Deißlingen  
Germany

+49 7420 692950

info@cbs-home.com

## ADMINISTRATION

CBS Home GmbH

Auf Stocken 4  
78073 Bad Dürkheim  
Germany

+49 7726 93872-240

info@cbs-home.com

[www.cbs-home.com](http://www.cbs-home.com)





Vitalisierende  
Produkte und  
Produktideen  
für Unternehmen

[www.witvital.de](http://www.witvital.de)



Lösungen bei  
Elektrosmog  
Wasserqualität  
Raumklima

[www.re-lux.com](http://www.re-lux.com)

**EINE TECHNIK  
EINE FORSCHUNG  
= GRENZLOSE  
MÖGLICHKEITEN**



INTELLIGENTE MONTAGESYSTEME

+43 316 482010  
office@ims-box.at  
ims-box.at



*Wir garantieren*

**MIT DER GRÜNEN BOX KÖNNEN  
SIE SICH SICHER SEIN**

- MASSGENAUIGKEIT
- FLEXIBLES DESIGN
- 100 % DICHT
- SCHALLGEPRÜFT
- MONTAGE-FREUNDLICHKEIT
- ZEITERSPARNIS
- DIREKTVERTRIEB
- VARIABLE OPTION
- PLANBARKEIT
- HERSTELLER-UNABHÄNGIGKEIT

**WIR KÜMMERN UNS UM IHRE IT,  
DAMIT SIE SICH AUF DAS WESENTLICHE KONZENTRIEREN KÖNNEN.**



MANAGED  
SERVICES



IT-SUPPORT



IT-SICHERHEIT



IT-INFRASTRUKTUR



CLOUD-LÖSUNGEN



MICROSOFT 365

**IT FÜR UNTERNEHMEN UND ÄRZTE**



ITSYSTEMHAUS  
NECKAR

Hohenkarpfenweg 1a  
78667 Villingendorf  
T: 0741 / 34887878  
M: info@it-systemhaus-neckar.de  
it-systemhaus-neckar.de



**BERATUNG AUF AUGENHÖHE**

BESTMÖGLICHES PREIS-LEISTUNGSANGEBOT

MEHRFACH AUSGEZEICHNETE & ZERTIFIZIERTE  
RISIKOABSICHERUNG

 UND WENN'S DRAUF ANKOMMT:  
TOP SCHADENMANAGEMENT  
MIT AKTIVEM EINSATZ UND  
SCHNELLER LEISTUNG



**LÖSUNGEN  
AUF DEN PUNKT**

**MARTENS/  
PRAHL/SPAICHINGEN**  
VERSICHERUNGSMAKLER